

ARC TROLLEY-S

ASSEMBLY INSTRUCTIONS

ASSEMBLY HARDWARE (INCLUDED):

P/N	DESCRIPTION	QTY
1	HALF ROUND HEAD HEXAGONAL SOCKET SCREW M6 x 12	31
2	HALF ROUND HEAD HEXAGONAL SOCKET SCREW M6 x 20	4
3	SELF-LOCKING NUT	35
4	SPRING WASHER M6	35
5	REAR WHEEL WASHERS	4
6	COTTER PIN	2

TOOLS (INCLUDED):

P/N	DESCRIPTION	QTY
7	OPEN END WRENCH	1
8	ALLEN KEY	1

STEP 1

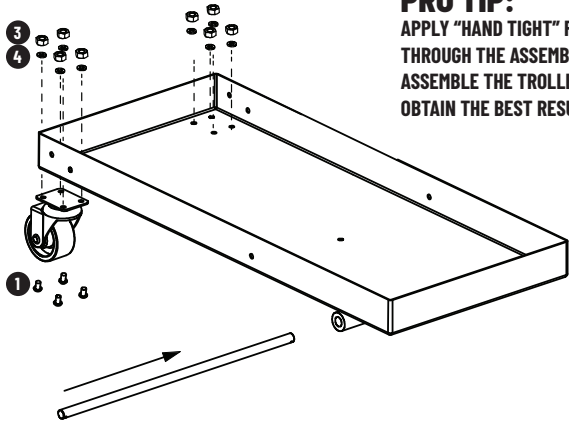

PRO TIP:
APPLY "HAND TIGHT" FORCE TO ALL SCREWS
THROUGH THE ASSEMBLY PROCESS.
ASSEMBLE THE TROLLEY ON A FLAT SURFACE TO
OBTAIN THE BEST RESULT.

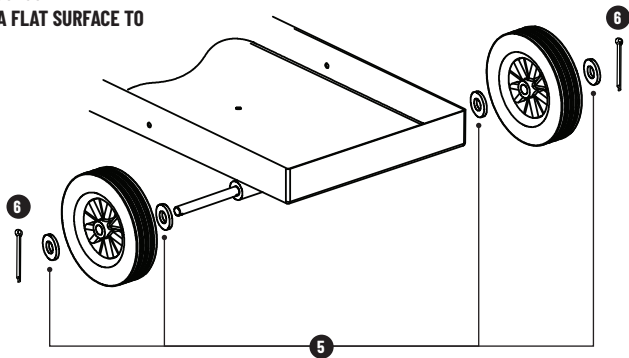

STEP 2

ASK SOMEONE TO HELP
HOLDING THE BACK OF THE
TROLLEY WHILE YOU ATTACH
THE MIDDLE SHELF AND
VERTICAL MEMBERS.

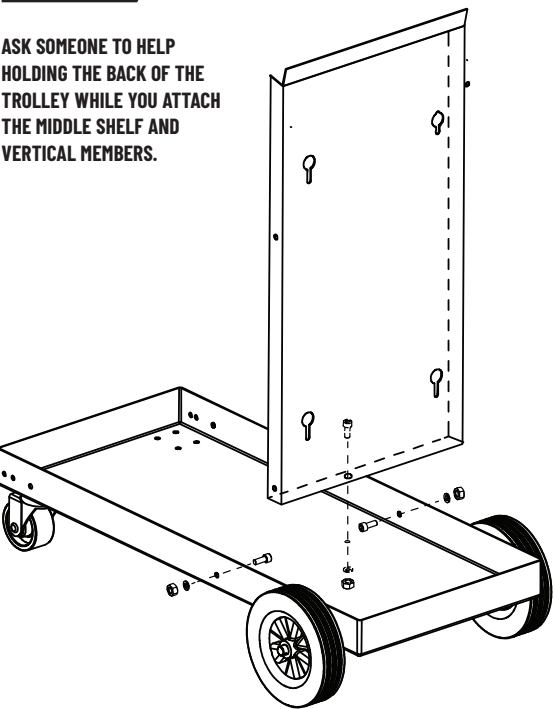

STEP 3

START BY FASTENING THE
SIDE VERTICAL MEMBERS,
THEN THE MIDDLE SHELF.

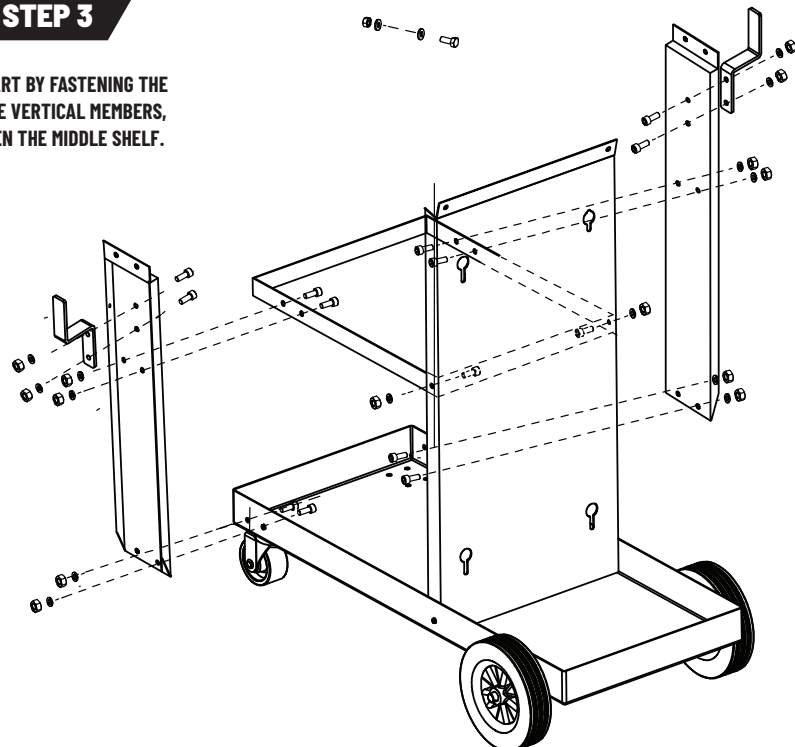

STEP 4

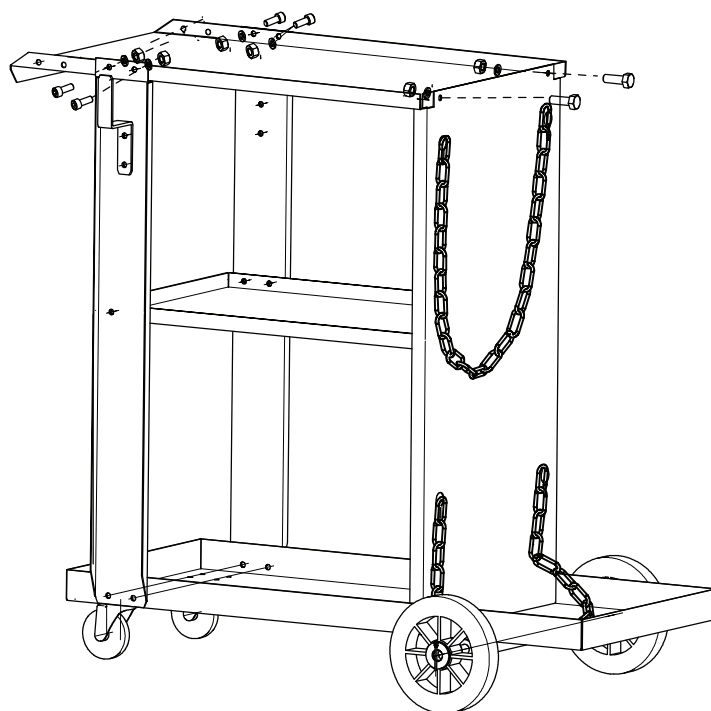

STEP 5

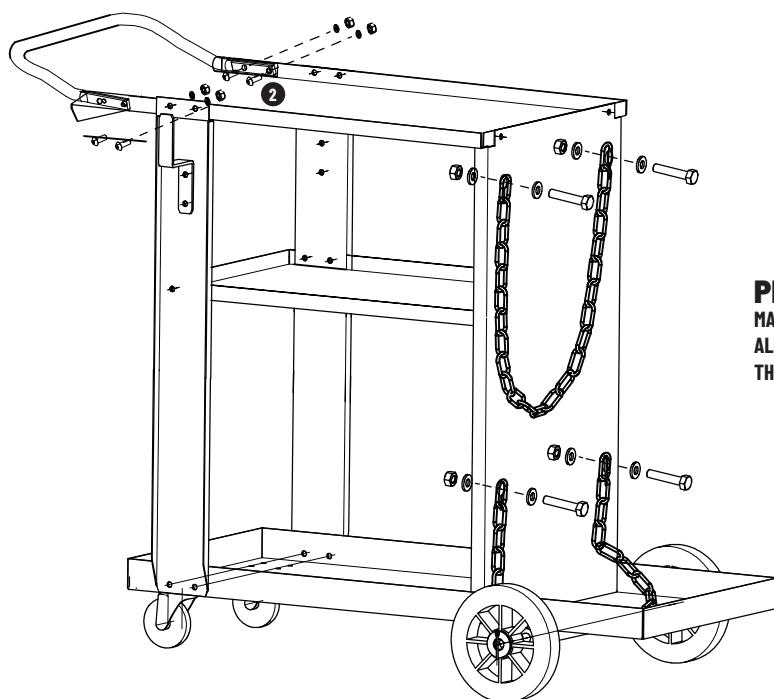

PRO TIP:
MAKE SURE TO FULLY TIGHTEN
ALL THE NUTS AND SCREWS AT
THIS POINT.